



PERFECT PILLARS  
Supporting You



## Flat 97, Bellville House 79 Norman Road, Greenwich, London, Asking price £350,000

- Top-floor one-bedroom apartment
- Private balcony
- Concierge service and lift access
- Close to Greenwich town centre and Greenwich Park
- Desirable south-west facing aspect
- Spacious open-plan living and kitchen area
- EPC rating B
- South-west facing living room and bedroom
- Modern Prime Place development
- Short walk to Greenwich station and DLR

400 Thames Valley Park Drive, Reading, Berkshire, RG6 1PT  
01183 048821

info@perfectpillars.co.uk  
<https://www.perfectpillars.co.uk/>

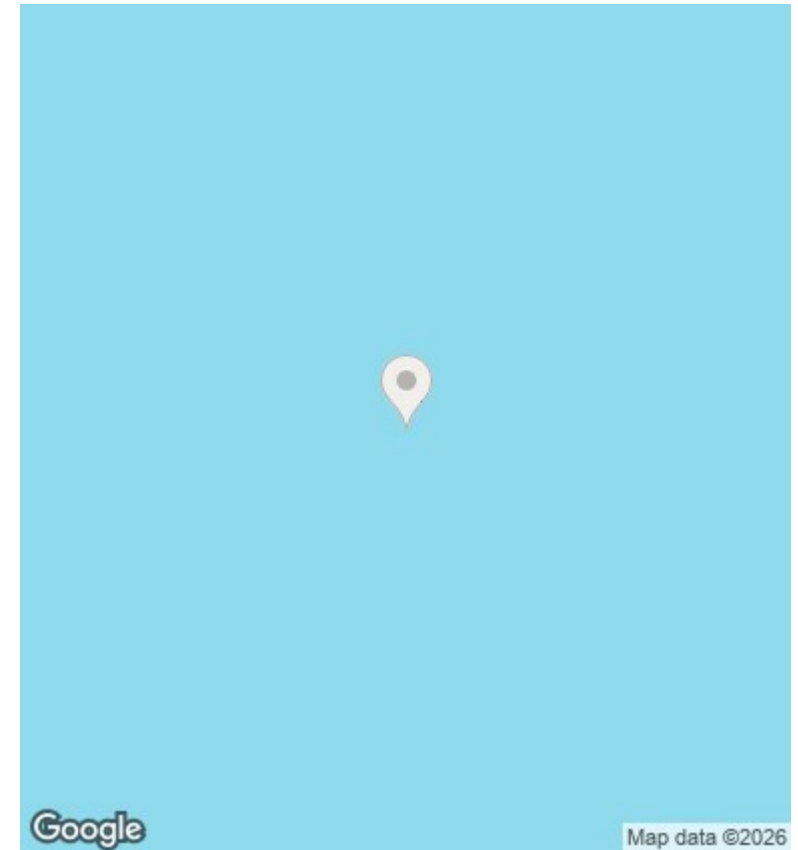
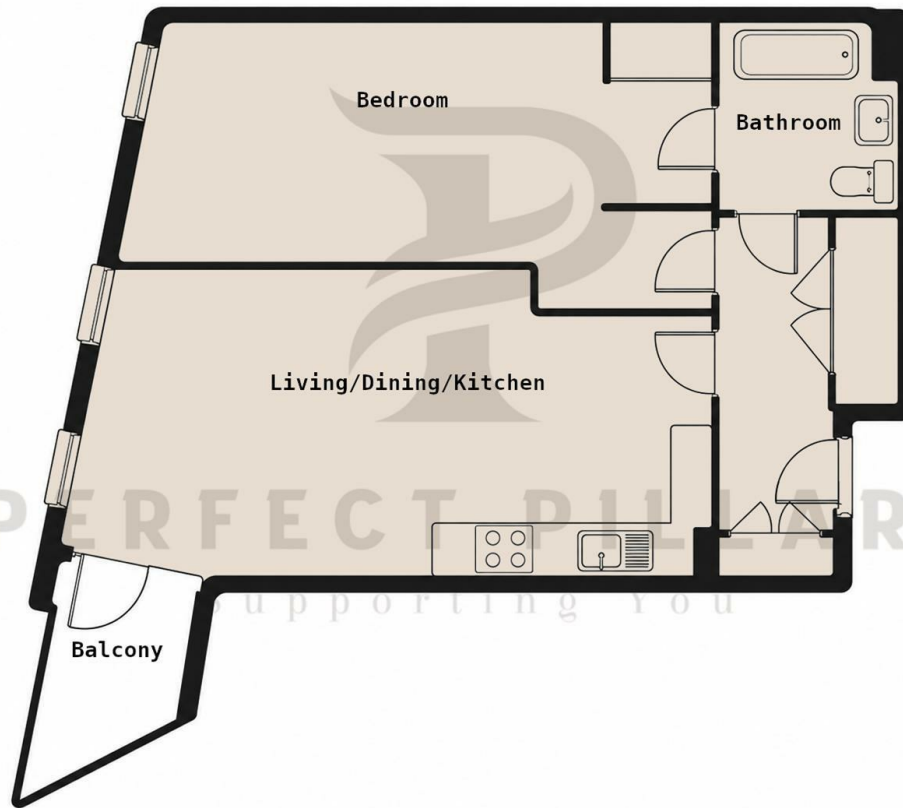

## Directions

## Viewings

Viewings by arrangement only. Call 01183 048821 to make an appointment.

## Council Tax Band

C

## EPC Rating:

B

Energy Efficiency Rating		Current	Potential
<i>Very energy efficient - lower running costs</i>			
(92 plus) <b>A</b>			
(81-91) <b>B</b>		<b>81</b>	
(69-80) <b>C</b>			
(55-68) <b>D</b>			
(39-54) <b>E</b>			
(21-38) <b>F</b>			
(1-20) <b>G</b>			
<i>Not energy efficient - higher running costs</i>			
<b>England &amp; Wales</b>		EU Directive 2002/91/EC	